

External-toothed Single Row Crossed Roller Slewing Bearings

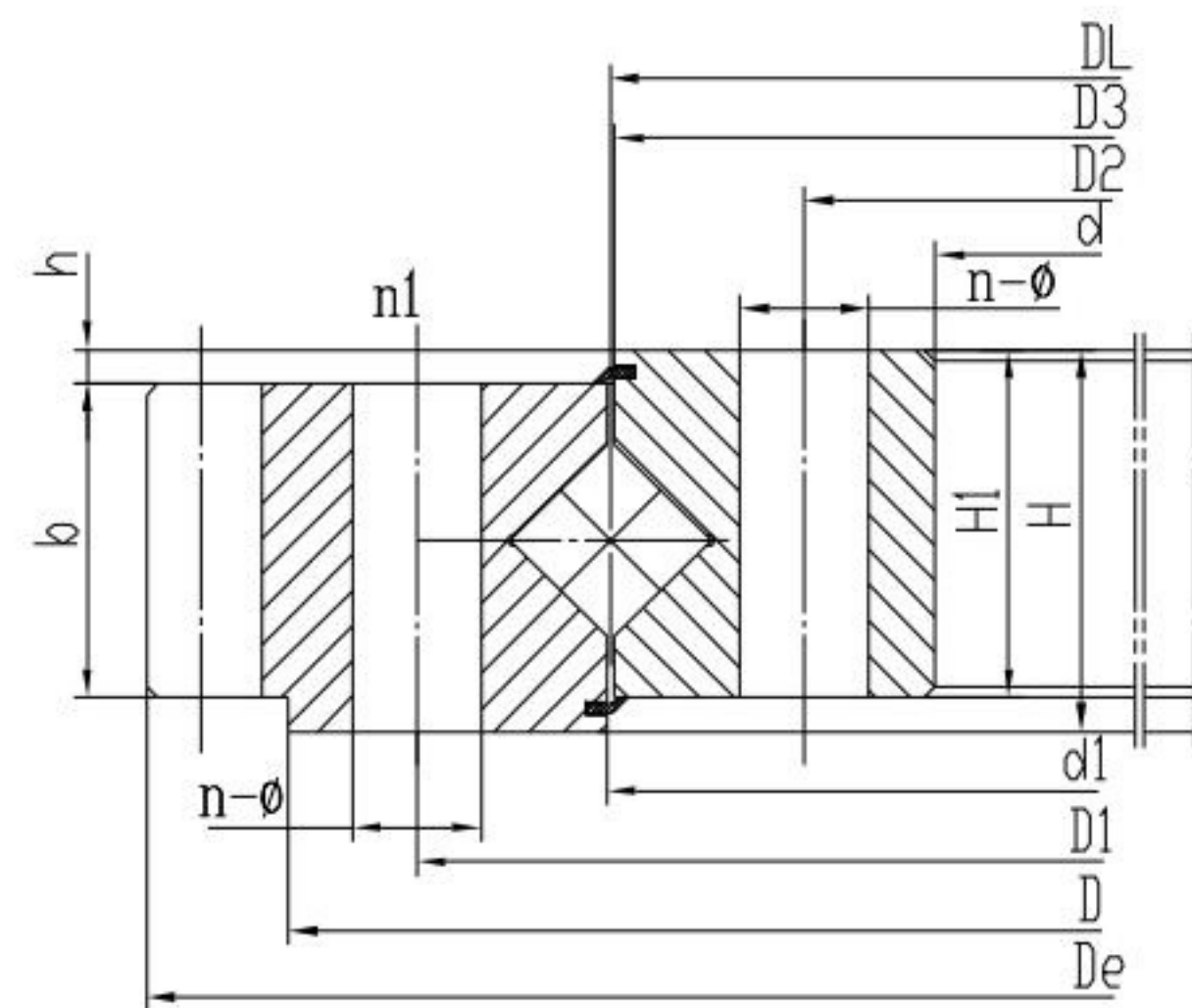

NOTE:

1. n1 is the number of lubricating oil holes, the customer can specify the location of oil holes according to the use situation.
2. n-φ can be changed into thread hole, thread diameter M, thread depth 2M.
3. The specifications in this sample are standard products, please contact SINOFOUV for any other special requirements.

Bearing Part Number	Boundary Dimensions				Mounting Hole Dimensions				Configuration Dimensions						Gear Parameter				Weight kg
	De	D	d	H	D1	D2	n	φ	D3	d1	H1	h	n1	M	m	Z	b	x	
	mm				mm			mm	mm					mm					
HJW500	629	602	398	75	566	434	20	18	498	502	65	10	4	16	5	123	60	+0.5	84
HJW500M	628.8	602	398	75	566	434	20	18	498	502	65	10	4	16	6	102	60	+0.5	84
HJW560	689	662	458	75	626	494	20	18	558	562	65	10	4	16	5	135	60	+0.5	92
HJW560M	688.8	662	458	75	626	494	20	18	558	562	65	10	4	16	6	112	60	+0.5	92
HJW630	772.8	732	528	75	696	564	24	18	628	632	65	10	4	16	6	126	60	+0.5	111
HJW630M	774.4	732	528	75	696	564	24	18	628	632	65	10	4	16	8	94	60	+0.5	111
HJW710	852	812	610	74	776	644	24	13.5	708	712	36.5	10	4	10	6	140	54	0	125
HJW710M	854.4	812	608	75	776	644	24	18	708	712	65	10	4	16	8	104	60	+0.5	125
HJW800	966.4	922	678	82	878	722	30	22	798	802	72	10	6	20	8	118	65	+0.5	179
HJW800M	968	922	678	82	878	722	30	22	798	802	72	10	6	20	10	94	65	+0.5	179
HJW823	979	853	715	100	893	753	28	22	821	825	84	21	4	20	10	94	63	1.1	193
HJW900	1062.4	1022	778	82	978	822	30	22	898	902	72	10	6	20	8	130	65	+0.5	189
HJW900M	1068	1022	778	82	978	822	30	22	898	902	72	10	6	20	10	104	65	+0.5	200
HJW1000	1188	1122	878	82	1078	922	36	22	998	1002	72	10	6	20	10	116	65	+0.5	242
HJW1000M	1185.6	1122	878	82	1078	922	36	22	998	1002	72	10	6	20	12	96	65	+0.5	242
HJW1025	1180	1150	885	115	1115	935	16	18	1021	1029	100	15	4	16	5	234	80	0	333
HJW1120	1272	1242	998	82	1198	1042	8	20	1118	1122	66	16	4	20	6	210	65	0	249
HJW1120M	1305.6	1242	998	82	1198	1042	36	22	1118	1122	72	10	6	20	12	106	65	+0.5	261
HJW1250	1449.6	1390	1110	91	1337	1163	40	26	1248	1252	81	10	5	24	12	118	75	+0.5	362
HJW1250M	1453.2	1390	1110	91	1337	1163	40	26	1248	1252	81	10	5	24	14	101	75	+0.5	362
HJW1262	1477	1400	1100	140	1352	1160	26	22	1260	1264	126	21	4	20	14	104	90	-0.24	607
HJW1400	1605.6	1540	1260	91	1487	1313	40	26	1398	1402	81	10	5	24	12	131	75	+0.5	417
HJW1400M	1607.2	1540	1260	91	1487	1313	40	26	1398	1402	81	10	5	24	14	112	75	+0.5	411
HJW1600	1817.2	1740	1460	91	1687	1513	45	26	1598	1602	81	10	5	24	14	127	75	+0.5	488
HJW1600M	1820.8	1740	1460	91	1687	1513	45	26	1598	1602	81	10	5	24	16	111	75	+0.5	484
HJW1800	2013.2	1940	1660	91	1887	1713	45	26	1798	1802	81	10	5	24	14	141	75	+0.5	530
HJW1800M	2012.8	1940	1660	91	1887	1713	45	26	1798	1802	81	10	5	24	16	123	75	+0.5	530

Internal-toothed Single Row Crossed Roller Slewing Bearings

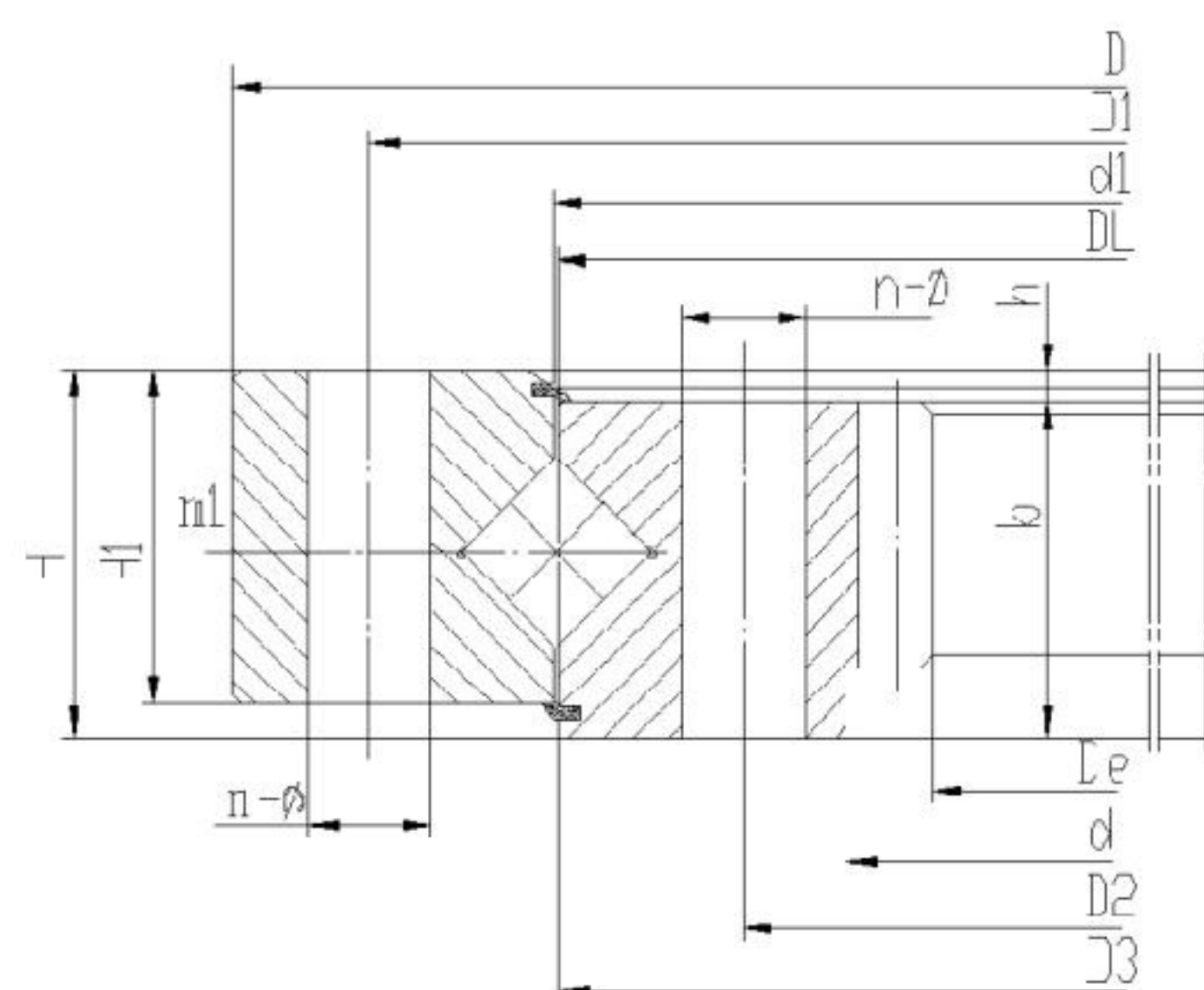

NOTE:

1. n1 is the number of lubricating oil holes, the customer can specify the location of oil holes according to the use situation.
2. n-φ can be changed into thread hole, thread diameter M, thread depth 2M.
3. The specifications in this sample are standard products, please contact SINOFOUV for any other special requirements.

Bearing Part Number	Boundary Dimensions				Mounting Hole Dimensions					Configuration Dimensions						Gear Parameter				Weight kg
	De	D	d	H	D1	D2	n	φ		D3	d1	H1	h	n1	M	m	Z	b	x	
	mm				mm			mm												
HJN500	367	602	398	75	566	434	20	18							498			502	65	10
HJN500M	368.4	602	398	75	566	434	20	18		498	502	65	10	4	16	6	62	60	+0.5	85
HJN560	427	662	458	75	626	494	20	18		558	562	65	10	4	16	5	86	60	+0.5	96
HJN560M	428.4	662	458	75	626	494	20	18		558	562	65	10	4	16	6	72	60	+0.5	96
HJN630	494.4	732	528	75	696	564	24	18		628	632	65	10	4	16	6	83	60	+0.5	110
HJN630M	491.2	732	528	75	696	564	24	18		628	632	65	10	4	16	8	62	60	+0.5	110
HJN710	572.4	812	608	82	776	644	24	18		708	712	65	10	4	16	6	96	60	+0.5	126
HJN710M	571.2	812	608	82	776	644	24	18		708	712	65	10	4	16	8	72	60	+0.5	122
HJN800	635.2	922	678	82	878	722	30	22		798	802	72	10	6	20	8	80	65	+0.5	186
HJN800M	634	922	678	82	878	722	30	22		798	802	72	10	6	20	10	64	65	+0.5	186
HJN817	685	920	712	70	880	751	30	22		815	819	60	10	5	20	5	139	53	0	115
HJN900	739.2	1022	778	82	978	822	30	22		898	902	72	10	6	20	8	93	65	+0.5	208
HJN900M	734	1022	778	82	978	822	30	22		898	902	72	10	6	20	10	74	65	+0.5	208
HJN1000	824	1122	878	82	1078	922	36	22		998	1002	72	10	6	20	10	83	65	+0.5	220
HJN1000M	820.8	1122	878	82	1078	922	36	22		998	1002	72	10	6	20	12	69	65	+0.5	220
HJN1094S	920	1216	920	100	1172	1013	12	22		1092	1096	90	10	4	20	10	94	90	0	393
HJN1120	944	1242	998	82	1198	1042	36	22		1118	1122	72	10	6	20	10	95	65	+0.5	273
HJN1120M	940.8	1242	998	82	1198	1042	36	22		1118	1122	72	10	6	20	12	79	65	+0.5	273
HJN1250	1048.8	1390	1110	91	1337	1163	40	26		1248	1252	81	10	5	24	12	88	75	+0.5	386
HJN1250M	1041.6	1390	1110	91	1337	1163	40	26		1248	1252	81	10	5	24	14	75	75	+0.5	390
HJN1400	1192.8	1540	1260	91	1487	1313	40	26		1398	1402	81	10	5	24	12	100	75	+0.5	441
HJN1400M	1195.6	1540	1260	91	1487	1313	40	26		1398	1402	81	10	5	24	14	86	75	+0.5	441
HJN1600	1391.6	1740	1460	91	1687	1513	45	26		1598	1602	81	10	5	24	14	100	75	+0.5	502
HJN1600M	1382.4	1740	1460	91	1687	1513	45	26		1598	1602	81	10	5	24	16	87	75	+0.5	517
HJN1800	1573.6	1940	1660	91	1887	1713	45	26		1798	1802	81	10	5	24	14	113	75	+0.5	605
HJN1800M	1574.4	1940	1660	91	1887	1713	45	26		1798	1802	81	10	5	24	16	99	75	+0.5	605
HJN2000	1734.4	2178	1825	112	2110	1891	48	33		1998	2002	100	12	8	30	16	109	90	+0.5	893